

COURTYARD®  
Marriott®

TAIPEI  
台北六福萬怡酒店

# BANQUET FUNCTION ROOM PLAN / CAPACITY / FEE CHART 宴會廳平面 / 容納 / 價目表

COURTYARD® TAIPEI



## Courtyard by Marriott® Taipei

台北六福萬怡酒店

No.359, Sec. 7, Zhongxiao E. Rd., Nangang Dist., Taipei City 115, Taiwan

11561 台北市南港區忠孝東路七段359號

T: 886.2.2171.6565

Courtyardtaipei.com

### Level 7 | Supernova Ballroom

超新星 大宴會廳

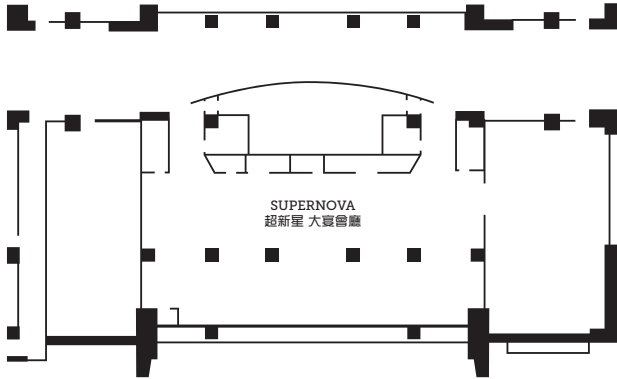

### Level 9 | BANQUET / MEETING ROOM

宴會廳 / 會議廳

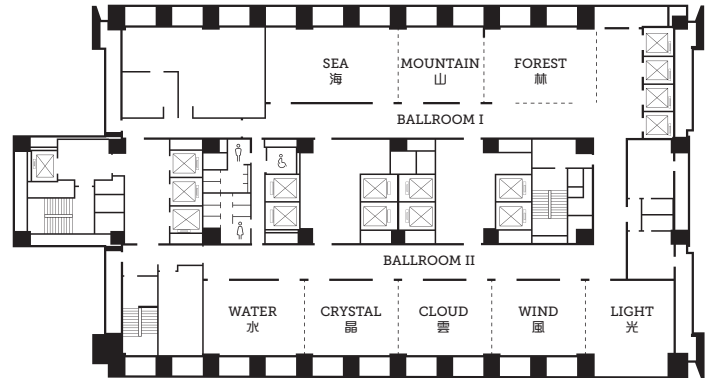

## BANQUET FUNCTION ROOM CAPACITY CHART

宴會廳容納及面積一覽表

### Capacity 座位席次

### Dimensions 尺寸

	By person 以人數計算					By Table 以桌數計算		Area 面積			Ceiling 樓高
	Theatre 劇院式	Classroom 課堂式	U Shape U字型	Hollow 口字型	Cocktail 酒會式	Banquet / Wedding 一般宴會 / 喜宴	Small Round 小圓桌	Ping 坪	Sq.Meters 平方公尺	Meters 公尺	
<b>Level 7</b>											
Supernova Ballroom 超新星 大宴會廳	400	180	—	—	200	25	30	128	423	3	
<b>Level 9</b>											
Ballroom I 海山林	250	120	80	104	100	10	20	63	205	2.7	
Ballroom I-A 海山	180	80	50	60	80	8	14	43	140	2.7	
Ballroom I-B 山林	150	80	44	50	60	7	12	38	123	2.7	
Sea 海	100	40	30	36	30	5	8	25	82	2.7	
Mountain 山	70	32	20	24	30	3	6	18	58	2.7	
Forest 林	70	32	20	24	30	3	6	20	65	2.7	
Ballroom II 水晶雲風光	450	240	136	144	150	20	35	91	304	2.7	
Crystal 水晶	180	72	48	56	60	6	12	36	118	2.7	
Wind 雲風光	280	128	80	88	90	13	18	56	186	2.7	

- Effective from August 1, 2016. All prices are quoted in NT dollars.
- Overnight set-up labor charge: NT\$1,000 per person per hour.
- All rates are subject to change without notice.

# Courtyard by Marriott® Taipei

台北六福萬怡酒店

No.359, Sec. 7, Zhongxiao E. Rd., Nangang Dist., Taipei City 115, Taiwan

11561 台北市南港區忠孝東路七段359號

T: 886.2.2171.6565

Courtyardtaipei.com

## Level 7 | Supernova Ballroom

超新星 大宴會廳

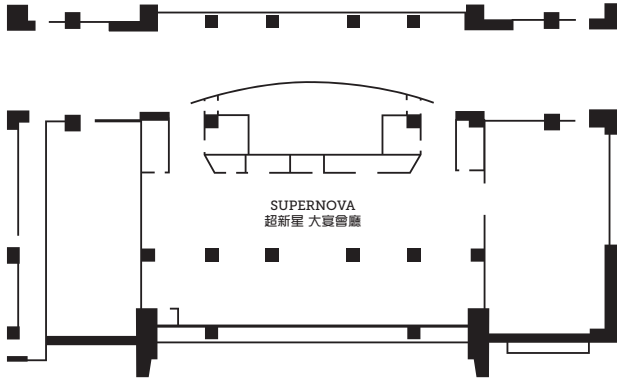

## Level 9 | BANQUET / MEETING ROOM

宴會廳 / 會議廳

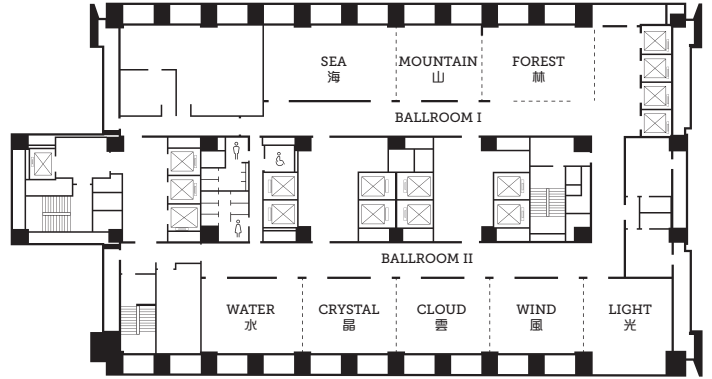

## BANQUET FUNCTION ROOM RENTAL FEE

宴會廳場地價目表

	Morning 上午 08:00 ~ 12:00	Afternoon 下午 13:00 ~ 16:30	Evening 晚上 18:00 ~ 22:00	Additional (Per Hour) 超時計費 (以小時計) 22:00 ~ 24:00	Full Day 24 Hours 全日24小時	Overnight Set-Up 24:00 Onward 夜間佈置(凌晨起)
<b>Level 7</b>	08:00 ~ 16:30					
Supernova Ballroom 超新星 大宴會廳	70,000	70,000	150,000	15,000	280,000	60,000
	140,000					
<b>Level 9</b>						
Ballroom I 海山林	35,000	35,000	57,000	5,700	120,000	15,000
	70,000					
Ballroom I-A 海山	27,000	27,000	42,000	4,200	90,000	10,000
	54,000					
Ballroom I-B 山林	24,000	24,000	35,000	3,500	80,000	10,000
	48,000					
Sea 海	15,000	15,000	25,000	2,500	45,000	10,000
	30,000					
Mountain 山	12,000	12,000	18,000	1,800	40,000	8,000
	24,000					
Forest 林	12,000	12,000	18,000	1,800	40,000	8,000
	24,000					
Ballroom II 水晶雲風光	55,000	55,000	80,000	8,000	150,000	18,000
	110,000					
Crystal 水晶	24,000	24,000	35,000	3,500	80,000	10,000
	48,000					
Wind 雲風光	36,000	36,000	52,000	5,200	120,000	12,000
	72,000					

- Effective from August 1, 2016. All prices are quoted in NT dollars.
- Overnight set-up labor charge: NT\$1,000 per person per hour.
- All rates are subject to change without notice.