

BANQUET FUNCTION ROOM
FLOOR PLAN /
CAPACITY & RENTAL CHART
宴會廳平面 / 容納 / 價目表

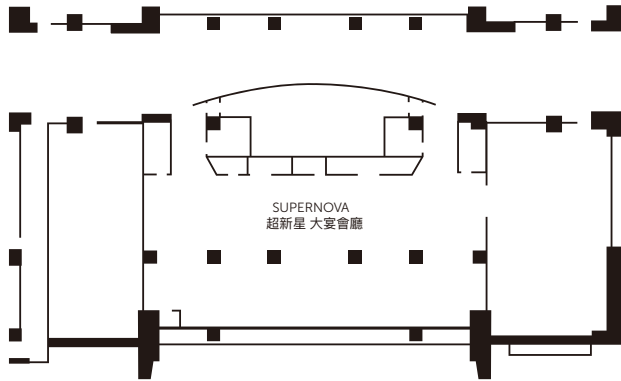

Level 7 | SUPERNOVA BALLROOM
超新星 大宴會廳



Level 9 | BANQUET / MEETING ROOM
宴會廳 / 會議廳

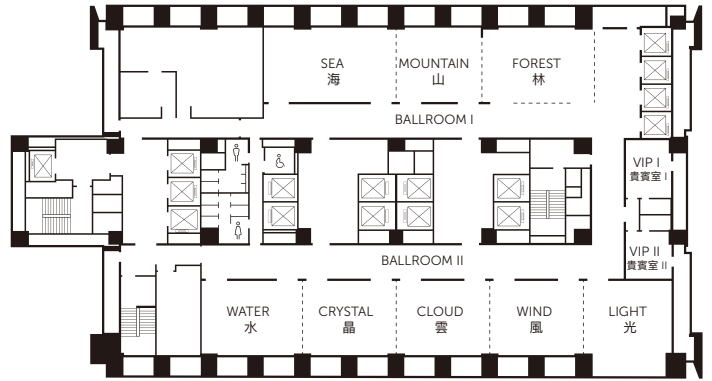

BANQUET FUNCTION ROOM CAPACITY CHART
宴會廳容納及面積一覽表

Capacity 座位席次

Dimensions 尺寸

	By person 以人數計算					By Table 以桌數計算		Area 面積		Ceiling 樓高
	Theatre 劇院式	Classroom 課堂式	U Shape 馬蹄型	Hollow 口字型	Cocktail 酒會式	Banquet / Wedding 一般宴會 / 喜宴宴會	Small Round 小圓桌	Ping 坪	Sq.Meters 平方公尺	Meters 公尺
Level 7										
SUPERNOVA BALLROOM 超新星 大宴會廳	400	180	—	—	200	25	30	128	423	3
Level 9										
Sea 海	100	40	30	36	30	5	8	25	82	2.7
Mountain 山	70	32	20	24	30	3	6	18	58	2.7
Forest 林	70	32	20	24	30	3	6	20	65	2.7
Ballroom I-A 海山	180	80	50	60	80	8	14	43	140	2.7
Ballroom I-B 山林	150	80	44	50	60	7	12	38	123	2.7
Ballroom I 海山林	250	120	80	104	100	10	20	63	205	2.7
Water+Crystal 水晶	180	72	48	56	60	6	12	36	118	2.7
Cloud+Wind+Light 雲風光	280	128	80	88	90	13	18	56	186	2.7
Ballroom II 水晶雲風光	450	240	136	144	150	20	35	91	304	2.7
VIP I 貴賓室 I	—	—	—	—	—	—	—	5.5	16.5	2.7
VIP II 貴賓室 II	—	—	—	—	—	—	—	5.5	16.5	2.7

• Effective from 01 Jan. 2020. Prices are subject to change without prior notice.
• All prices are in NT Dollars and inclusive 5% tax and 10% service charge.

Level 7 | SUPERNOVA BALLROOM
 超新星 大宴會廳

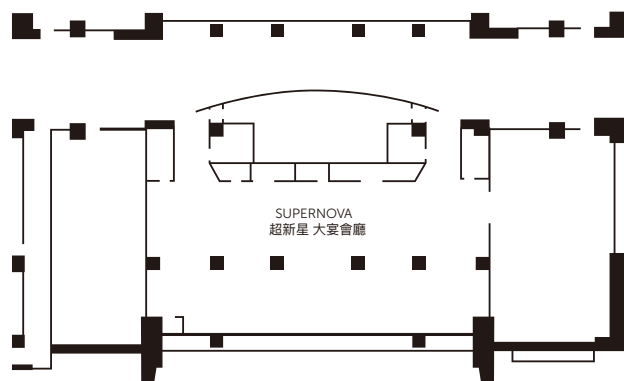

Level 9 | BANQUET / MEETING ROOM
 宴會廳 / 會議廳

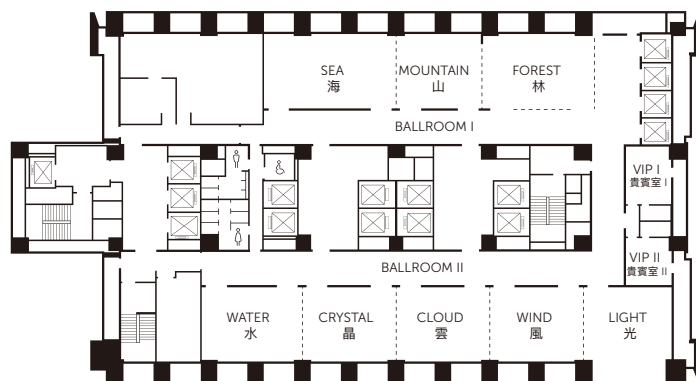

BANQUET FUNCTION ROOM RENTAL CHARGE
 宴會廳場地價目表

	Morning 上午 08:00 ~ 12:00	Afternoon 下午 13:00 ~ 16:30	Evening 晚上 18:00 ~ 22:00	Additional (Per Hour) 超時計費 (以小時計) 22:00 ~ 24:00	Full Day 24 Hours 全日24小時	Overnight Set-Up 24:00 Onward 夜間佈置(凌晨起)
Level 7	08:00 ~ 16:30					
SUPERNOVA BALLROOM 超新星 大宴會廳	95,000	95,000	280,000	20,000	352,000	42,000
	190,000					
Level 9						
Sea 海	24,000	24,000	54,000	6,000	80,000	14,000
	48,000					
Mountain 山	21,000	21,000	36,000	4,000	60,000	10,000
	42,000					
Forest 林	21,000	21,000	36,000	4,000	60,000	10,000
	42,000					
Ballroom I - A 海山	36,000	36,000	90,000	10,000	120,000	18,000
	72,000					
Ballroom I - B 山林	33,000	33,000	72,000	8,000	100,000	16,000
	66,000					
Ballroom I 海山林	46,500	46,500	144,000	12,000	180,000	26,000
	93,000					
Water 水	21,000	21,000	36,000	4,000	60,000	10,000
	42,000					
Crystal 晶	21,000	21,000	36,000	4,000	60,000	10,000
	42,000					
Cloud 雲	21,000	21,000	36,000	4,000	60,000	10,000
	42,000					
Wind 風	21,000	21,000	36,000	4,000	60,000	10,000
	42,000					
Light 光	21,000	21,000	36,000	4,000	60,000	10,000
	42,000					
Water+Crystal 水晶	33,000	33,000	72,000	8,000	100,000	16,000
	66,000					
Cloud+Wind+Light 雲風光	45,000	45,000	108,000	12,000	150,000	28,000
	90,000					
Ballroom II 水晶雲風光	68,000	68,000	180,000	16,000	240,000	34,000
	136,000					
VIP Room I & II 貴賓室	9,000	9,000	12,000	2,500	30,000	6,000
	18,000					

• Effective from 01 Jan. 2020. Prices are subject to change without prior notice.
 • All prices are in NT Dollars and inclusive 5% tax and 10% service charge.